



SPECIFICATION

APPLICATION:

The eye wash is intended for rinsing eyes and face in case of contact with irritating chemical substances or dust contamination. Eyes are rinsed with a delicate aerated stream. It is a free-standing device, that is mounted to the floor. Only for indoor installation. The structure is made of polished stainless steel grades 304 and 316. OHS sign with pictogram and instruction manual is enclosed.

ACTUATING:

The device is actuating in two ways. By pressing the flag handle with your hand or elbow. Valve is activated by flag handle or foot treadle. Unit remains in operation until flag handle is returned to closed position.

SUPPLY:

The eye wash has a valve at the end 3/8" internal thread. The device is being connected to cold water, for example, with a flexible hose. Valves mixing cold and hot water can be used, but it is not required. Water used flows down the pipe, which is the construction of the device. Minimum pressure 2.6 bar.

CERTIFICATES:

The device is certified by the National Institute of Hygiene and has a declaration of conformity confirming its compliance with the European standard PN-EN 15154-2:2006 Emergency showers – Laboratory Safety - Part 2: Plumbing Eye Washers. Copies of both documents are enclosed with the device.



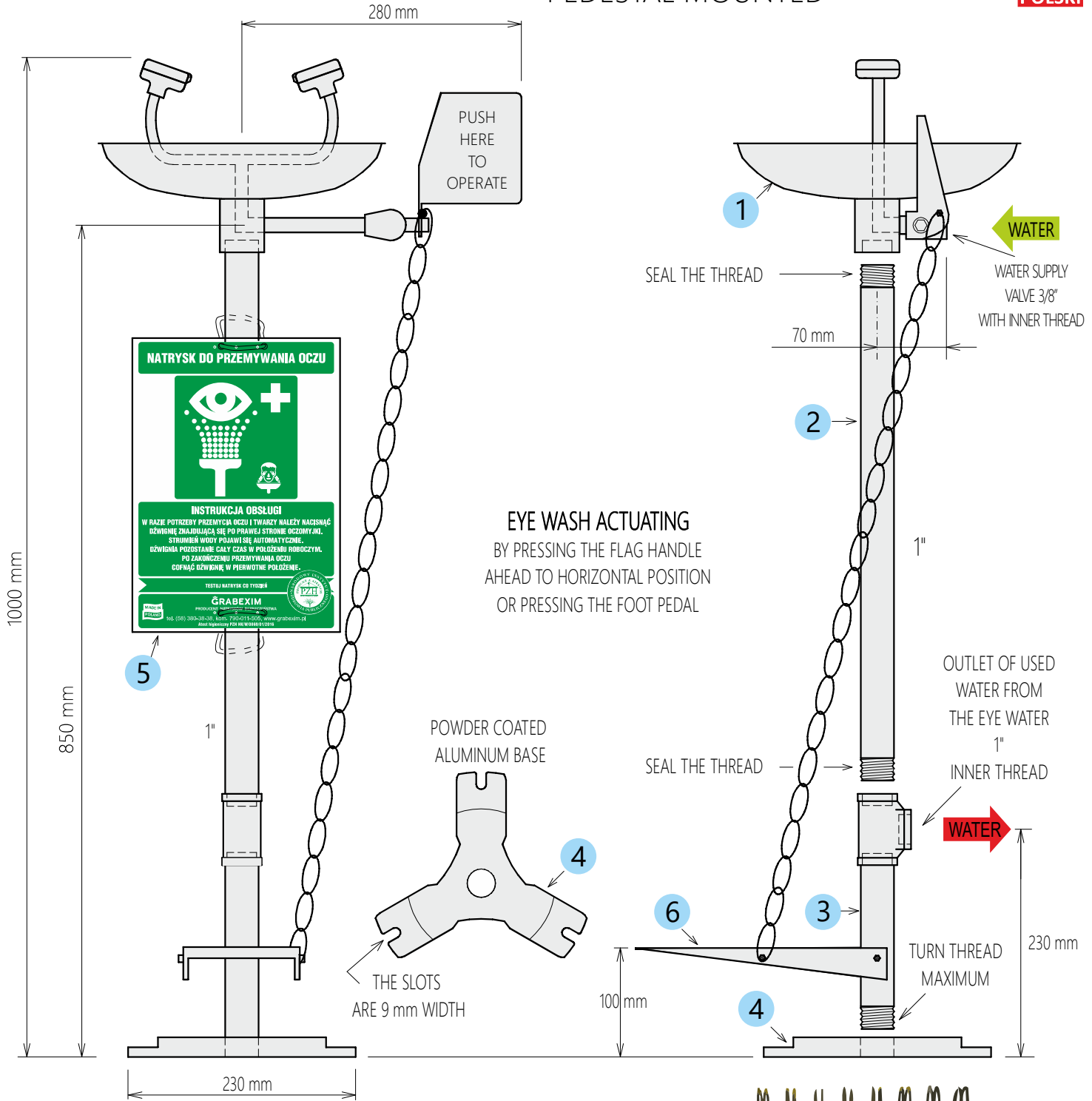

INSTALLATION

1. Check package contents.
2. Prepare thread sealing materials e.g. tow plumbing flax and paste, in sufficient quantity to seal two 1" threads (not included).
3. Prepare 3 screws or anchors to fasten device to the floor (not included).
4. Assemble according to the attached drawing, hang a safety sign.



G25-PED	
number	LIST OF EMENTS
1	Eye wash module <input type="checkbox"/>
2	Pipe L=640 mm <input type="checkbox"/>
3	Stand <input type="checkbox"/>
4	Aluminium base <input type="checkbox"/>
5	Safety sign + docs. <input type="checkbox"/>
6	Foot treadle <input type="checkbox"/>